



# TLI-1020A

- > RECHARGEABLE
- > Up to 5000 cycles
- > Extremely low self discharge rate
- > Charging possible at extreme temperatures

## Performance Data

(Typical values for batteries stored at +25 °C for one year)

System	Lithium Intercalated Compounds	
Nominal voltage	4 V	
Max. capacity	25 mAh	
Max. continuous discharge current	160 mA	
Pulse current capability	400 mA	
Discharge end voltage	2.5 V	
Max. charge voltage	4.1 V	
Max. charge current	8 mA	1.6 mA
Temperature range	-20 °C ... +50 °C	-40 °C ... +85 °C
Cell impedance @ 1 kHz, RT	max. 600 mΩ	
Nominal energy	max. 0.09 Wh	
Weight	4.2 g	

For more information please refer to page 46.



Discharge Curve at 25 °C

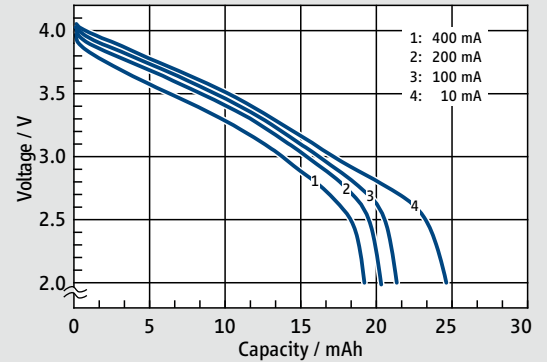

Discharge Curve at 100 mA

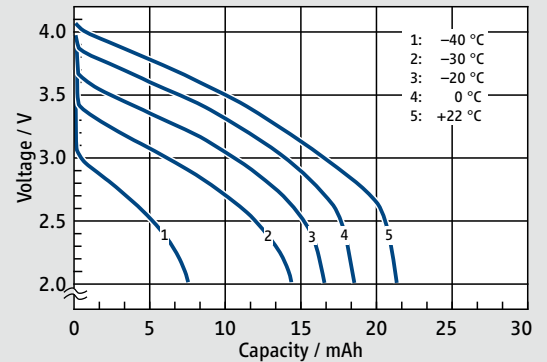

## TLI-1020A/S

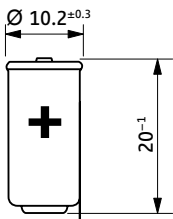

## TLI-1020A/T

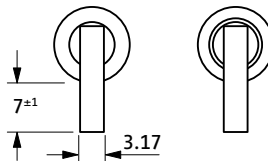

## TLI-1020A/TP

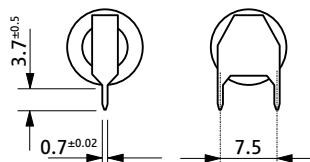

Cycling Performance

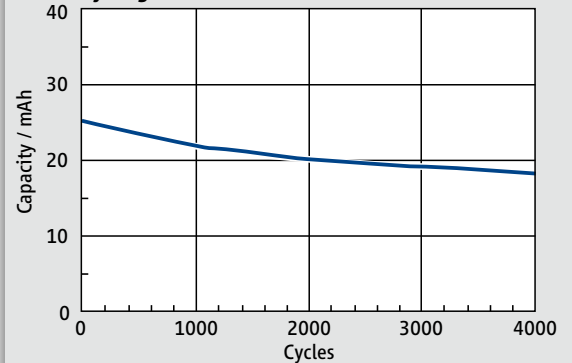

## Available Terminations

Termination	Standard	Catalogue No.
TLI-1020A/S	Standard	13 2 11021 02
TLI-1020A/T	Tags	13 2 11022 02
TLI-1020A/TP	Polarized tags	13 2 11027 02

**Warning:**  
Fire, explosion,  
and severe burn hazards.  
Do not disassemble, heat  
above 100 °C, short circuit,  
incinerate or expose  
contents to water.

Do not charge above 4.1 V.  
Please refer to TLI-guidelines.